

DIMENSIONS SHOWN ON THIS PLAN ARE IN MILLIMETRES UNLESS OTHERWISE NOTED

CONTRACT No. Q-LAS-25-03
DRAWING No. 25-P-09 (L6)
SHEET No.
6 OF Total 10

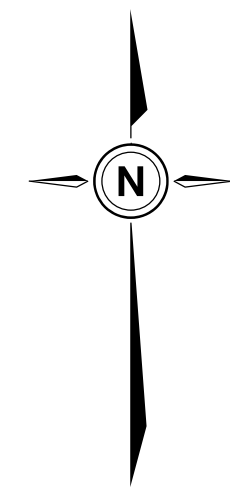

- NOTE:
- 1) CONTRACTOR TO REVIEW LAYOUT OF PROJECT ON SITE WITH CITY REPRESENTATIVE PRIOR TO CONSTRUCTION.
 - 2) CONTRACTOR IS RESPONSIBLE FOR PROVIDING SITE PROTECTION MEASURES AS PER THE OCCUPATIONAL HEALTH AND SAFETY ACT O.REG. 213/19 S.65.
 - 3) PARKING, DRIVING, AND STORAGE ARE NOT PERMITTED OUTSIDE OF THE LIMIT OF CONSTRUCTION, SITE ACCESS ROUTE, AND STAGING AREA
 - 4) SITE ACCESS ROUTE SHALL BE USED ONLY FOR TRANSPORT OF EQUIPMENT AND MATERIALS. PARKING AND STORAGE ARE NOT PERMITTED
 - 5) THIS IS NOT A PLAN OF SURVEY. INFORMATION SHOWN IS DERIVED FROM FIELD SURVEY COMBINED WITH INFORMATION DERIVED FROM EXISTING RECORDS.

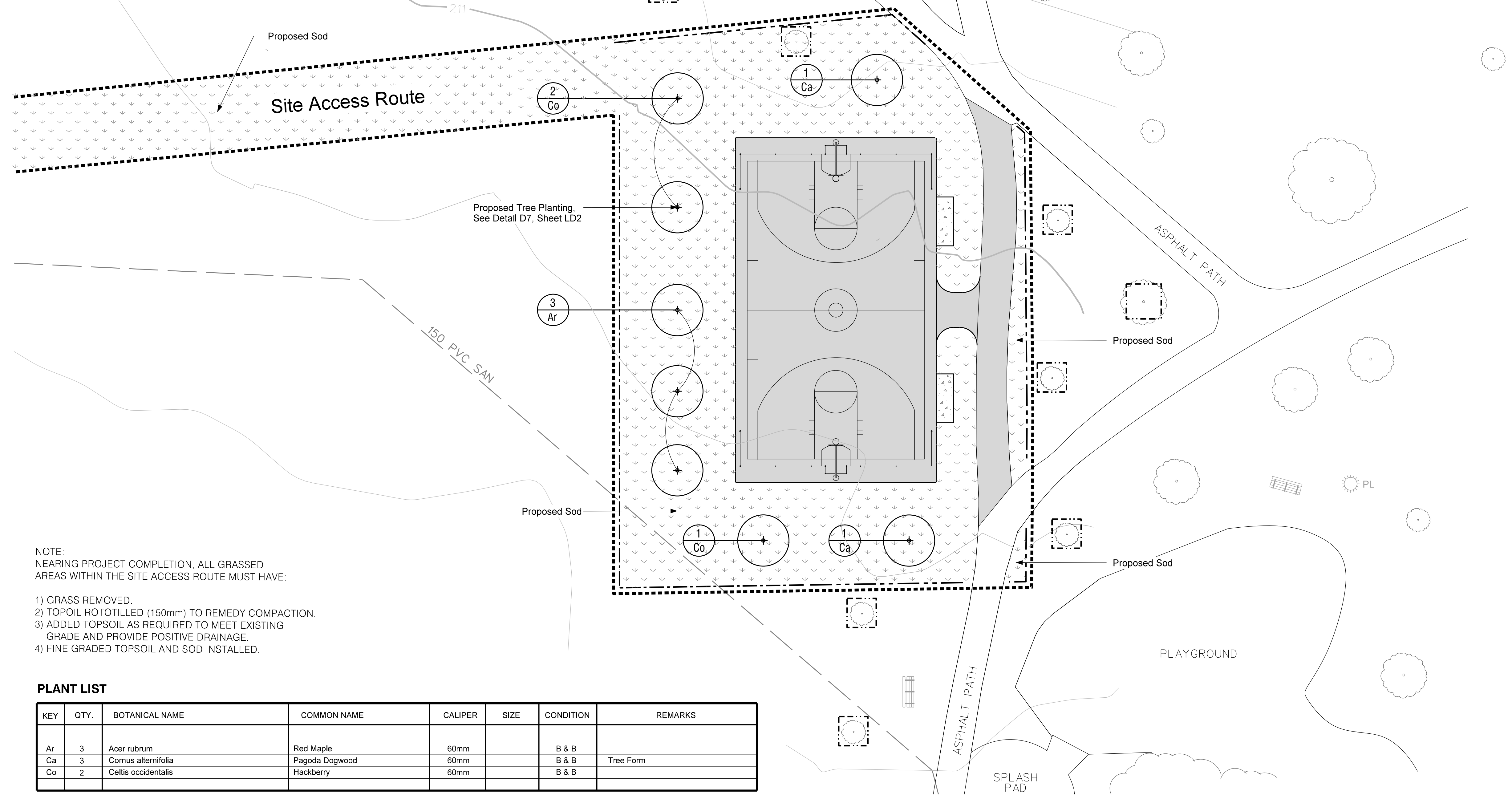

NOTE:
NEARING PROJECT COMPLETION, ALL GRASSED AREAS WITHIN THE SITE ACCESS ROUTE MUST HAVE:

- 1) GRASS REMOVED.
- 2) TOPOIL ROTOTILLED (150mm) TO REMEDY COMPACTION.
- 3) ADDED TOPSOIL AS REQUIRED TO MEET EXISTING GRADE AND PROVIDE POSITIVE DRAINAGE.
- 4) FINE GRADED TOPSOIL AND SOD INSTALLED.

PLANT LIST

KEY	QTY.	BOTANICAL NAME	COMMON NAME	CALIPER	SIZE	CONDITION	REMARKS
Ar	3	Acer rubrum	Red Maple	60mm		B & B	
Ca	3	Cornus alternifolia	Pagoda Dogwood	60mm		B & B	Tree Form
Co	2	Celtis occidentalis	Hackberry	60mm		B & B	

LIMIT OF CONSTRUCTION, SITE ACCESS ROUTE AND STAGING AREA BOUNDARIES	-----
PROPOSED TREE PLANTING	⊕
PROPOSED ASPHALT	▒
PROPOSED CONCRETE	▒
PROPOSED SOD	▒
PROPOSED TREE PROTECTION FENCE	-----
PROPOSED SEDIMENT CONTROL FENCE (TRENCHED)	-----
PROPOSED SEDIMENT CONTROL FENCE (NON-TRENCHED)	-----
EXISTING PROPERTY LINE	-----
EXISTING MAJOR CONTOURS	----- 211
EXISTING MINOR CONTOURS	-----
EXISTING SANITARY SEWER	-----
EXISTING STORM SEWER	-----
EXISTING WATERMAIN	-----
EXISTING DITCH INLET	□
EXISTING STORM MANHOLE	○ SMH
EXISTING CATCH BASIN	○ CB
EXISTING LIGHT POLE	○ PL
EXISTING WOODEN HYDRO POLE	○ WHP
EXISTING CHAIN FENCE	-----
EXISTING TREES	⊙
EXISTING SOCCER GOAL	⊕
EXISTING SIGN	○ SIGN
EXISTING PARK LIGHT	⊙ PL
EXISTING BENCH	▒
EXISTING BOLLARDS	○ ○
EXISTING ARMOUR STONE	▒

No.	REVISIONS	INITIAL	DATE	DRAWN BY: JJ	DATE: October 15, 2025
1	ISSUED FOR CONSTRUCTION	JJ	26/02/25		

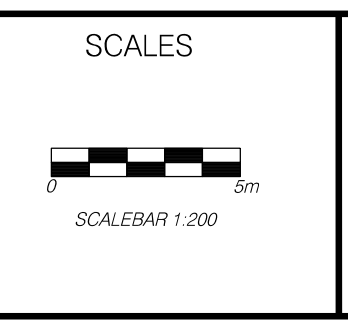

REFERENCE MATERIAL:
Road Plans :
Sewer Plans :
Water Plans :
Regional Surveyor :
Geodetic Bench Mark Index No.
Elevation=

Landscape Architectural Services
Hailey Johnston
Manager, Landscape Architectural Services
Wes Kindree

City of Hamilton
Public Works Department

MAPLEWOOD PARK MULTI-USE COURT
Planting Plan

L6